

# Geared trolley - "MC" type

The machines are planned in conformity with the 2006/42/EEC Directive

With : EC markings  
EC declaration of conformity  
Statement report-Fitting for use  
Information for use



**INTENDED USE** The manual geared trolley MC type are exclusively planned to move the weight applied to the chain hoist, running on the lower flanges of the beam, in conditions of safe and controlled efficiency, respecting the measures and limits of use as described in the Information of use, and using the authorized lifting machine and accessories.

## TECHNICAL AND CONSTRUCTION CHARACTERISTICS :

**Sides:** in steel sheet, above which the pins of the motion

**Lower tie-rod:** in steel, stopped on the sides by nuts washers and split pins and provided, with various depth spacers, in order that the trolley is adjustable to the beam.

**Motion wheels:** in cast iron, mechanically worked, with a rolling strip appropriate to the expected running beam.

The wheels are supported on permanently lubricated ball bearings (simple or double).  
Two wheels are idle and two wheels are driving

**Moving pulley:** molten, with pockets, fixed on a central tree through nut and split pin ; the tree, provided with gearwheel, engage with the crown wheel of the driving wheels.

**Moving chain:** in round steel, running on the moving pulley, with steel lateral chain guide, fixed on the side.

**Trolley plate (for hoist) :** is the base and the hanging point of the lifting unity, in steel, with an appropriate shaped buttonhole.

**Trolley control:** is activated by pulling manually one of the descent falls of the motion chain rolling the correspondent pulley and afterwards, the central wheelgear and the driving wheels.

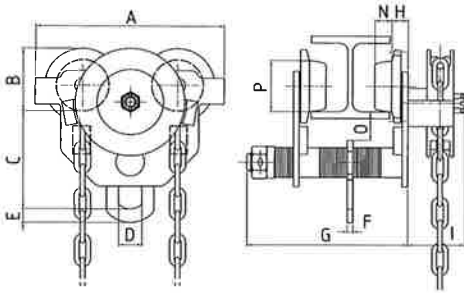

500 KG - 5000 KG TROLLEY

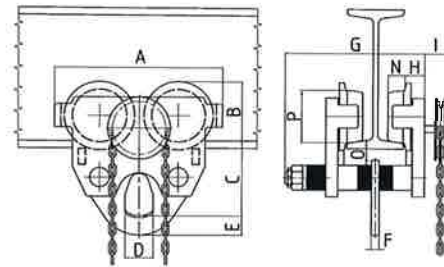

10000 and 20000 KG TROLLEY

<b>CAPACITY</b>		<b>kg</b>	<b>500</b>	<b>1.000</b>	<b>1.500</b>	<b>2.000</b>	<b>3.000</b>	<b>5.000</b>	<b>10.000</b>	<b>20.000</b>
Displacement with 5 mt hand chain		mm	1.196	1.484	1.507	1.509	1.112	1.110	994	530
Effort on the chain		kg	2.5	5	7	9	9.5	14	24	25
Minimum radius		m	0,8	1,0	1,0	1,1	1,3	1,4	2,0	3,5
Measure A		mm	200	246	261	275	333	377	423	555
Measure B		mm	67	81	88	94	115	126	155	200
Measure C		mm	105	125	132	141	167	192	190	240
Measure D		mm	24	27	31	37	39	49	71	92
Measure E		mm	14	15	17	20	23	31	50	63
Measure F		mm	6	8	10	12	14	16	20	30
Measure G with tie-rod A		mm	169	212	217	237	265	- -	- -	- -
Measure G with tie-rod B		mm	220	282	282	293	303	318	349	406
Measure G with tie-rod C		mm	269	384	384	395	406	418	450	508
Measure H		mm	17	22	22	26	28	38	48	75
Measure I		mm	60	60	60	60	60	60	60	90
Measure N		mm	17	19	21	23	26	35	42	53
Measure O		mm	30	37	37	36	38	41	42	57
Measure P		mm	55	68	74	79	99	109	135	175
Trolley with tie-rod A type	Beam lower flange width	mm	50 - 100	58 - 131	70 - 135	80 - 143	100 - 150	- -	- -	- -
	Weight	kg	8,50	12,00	14,00	19,00	28,00	- -	- -	- -
	Model and order code		MC500A	MC1000A	MC1500A	MC2000A	MC3000A	- -	- -	- -
Trolley with tie-rod B type	Beam lower flange width	mm	50 - 150	58 - 200	70 - 200	80 - 200	100 - 200	106 - 200	120 - 200	131 - 200
	Weight	kg	8,70	12,50	14,70	20,00	29,00	43,00	73,00	159,00
	Model and order code		MC500B	MC1000B	MC1500B	MC2000B	MC3000B	MC5000B	MC10000B	MC20000B
Trolley with tie-rod C type	Beam lower flange width	mm	50 - 200	58 - 300	70 - 300	80 - 200	100 - 300	106 - 300	120 - 300	131 - 300
	Weight	kg	9,00	13,50	16,00	21,00	31,00	45,00	78,00	166,00
	Model and order code		MC500C	MC1000C	MC1500C	MC2000C	MC3000C	MC5000C	MC10000C	MC20000C
Weight for each mt more of chain		kg	0,9							