

# Manual spur gear rope winch " CL "Type

The machines are planned in conformity with the 2006/42/EEC Directive

**With :** EC markings  
EC declaration of conformity  
Statement report-Fitting for use  
Information for use



**INTENDED USE** The manual winch "CL" and "CLV" type are planned only to lift free weights in the space, straight up, or towing loads, in condition of safe and controlled efficiency, in according to the measures and limits of use as described in the instruction of use and using suitable accessories.

## TECHNICAL AND CONSTRUCTION CHARACTERISTICS :

**Structure:** compact and light execution made of two steel plates

**Mechanism** All gearings, and drum, are revolving on permanent lubrication ball bearings.

**Crank handle :** adjustable and removable

**Brake:** with a safety jump to stop the weight in the wanted position. The brake is automatic and has two bronze friction disk.

**Winch control :** through manual rotation of crank handle.

## MOUNTING POSITION :

On the flat or wall-mounted. The special design allows the crank handle to rotate without interfering with the ground plane.

**STAINLESS STEEL : 250-500-1000 KG CAPACITY ARE AVAILABLE ALSO IN TOTALLY STAINLESS STEEL.**

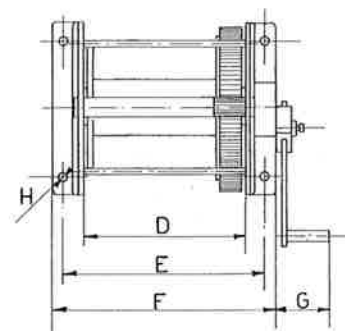
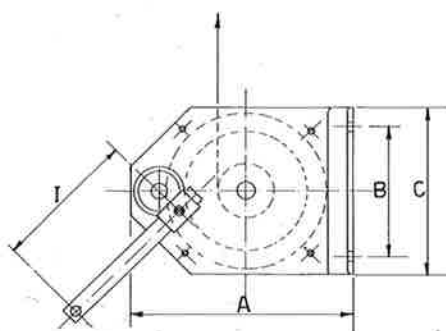
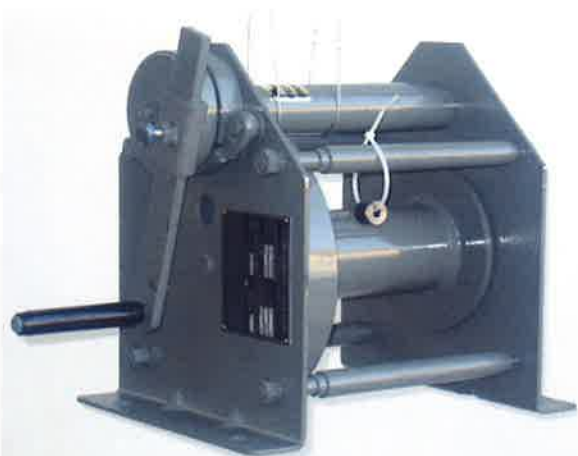

CAPACITY		kg	250	500	1.000	1.500
MODEL			CLM250	CLM500	CLM1000	CLM1500
Drum diameter		mm	54	76	95	114
Maximum rope diameter		mm	5	7	9	11
The rope must have a minimum breaking load		kg	1.250	2.500	5.000	7.500
Rope example	Rope 133 / 205 wires	mm	4 / 133	6 / 133	8 / 205	10 / 205
	Rope breaking load	kg	1.250	2.640	5.000	8.200
	Rope capacity	m	35	35	40	45
	Lift per crank revolution	mm	35	33	29	28
		kg	15	20	23	26
Measure A		mm	250	310	420	540
Measure B		mm	120	160	250	300
Measure C		mm	190	250	360	440
Measure D		mm	140	220	270	330
Measure E		mm	184	270	330	415
Measure F		mm	220	310	380	470
Measure G		mm	110	115	160	160
Measure H		mm	12	14	16	18
Measure I		mm	150	200	300	400
Weight		kg	11	24	42	70

1.000	2.000	3.000	5.000
CLV1000	CLV2000	CLV3000	CLV5000
95	140	168	219
9	13	16	20
5.000	10.000	15.000	25.000
8 / 205	12 / 133	14 / 205	18 / 205
5.000	10.570	16.500	26.700
200	200	200	200
48	20	13,5	9
20 + 20	15 + 15	16 + 16	18 + 18
500	620	750	950
300	400	500	600
380	510	640	830
370	510	625	760
440	590	720	870
485	645	785	940
200	200	200	200
18	20	22	25
350	350	350	350
70	140	220	400